



www.americanringmfg.com

## 5100-118 Retaining Ring Spec Sheet



**Part Number: 5100-118**

5100 Series - External Retaining Ring With Lugs



Beam configuration on some larger sizes



Some small sizes (Mfr. Option)

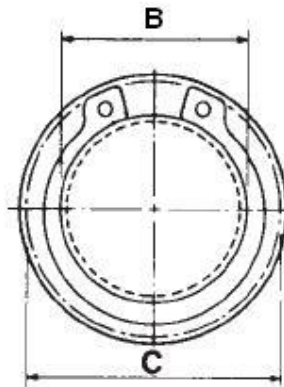
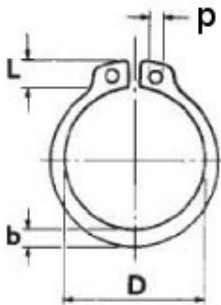

When Sprung onto Shaft

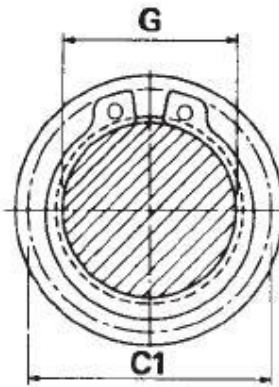

When Sprung into Groove

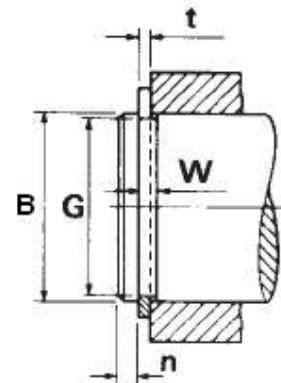

### Ring Specs

<b>(D) Free Diameter:</b>	1.098 +0.010 / -0.015 in.
<b>(t) Thickness:</b>	0.050 +0.002 / -0.002 in.
<b>(b) Radial Wall:</b>	

### Groove Specs:

<b>(B) Application Diameter:</b>	1.188	in.
<b>(G) Groove Diameter:</b>	1.118 +0.004 / -0.004	in.
<b>(W) Groove Width:</b>	0.056 +0.004 / -0.000	in.
<b>Groove Depth:</b>	0.035	in.

### Other Specs

<b>Approximate Weight per 1000:</b>	5.600	lbs.
<b>(C1) Clearance Diameter &amp; Gauging Diameter Seated in Groove</b>	1.540	in.
<b>(C) Clearance Diameter Expanded Over Shaft</b>	1.610	in.

